



apeks
Regulator Owner's Manual

Copyright Notice

This owner's manual is copyrighted, all rights reserved. It may not, in whole or in part, be copied, photocopied, reproduced, translated or reduced to any electronic medium or machine readable form without prior consent in writing from Apeks.

©2005 Apeks
Regulator Owner's Manual

P/N AP5310AA

Warnings, Cautions and Notes

Pay special attention to information provided in warnings, cautions and notes, that is accompanied by these symbols:



A **WARNING** indicates a procedure or situation that, if not avoided, could result in serious injury or death to the user.



A **CAUTION** indicates any situation or technique that could cause damage to the product, and could subsequently result in injury to the user.



A **NOTE** is used to emphasize important points, tips, and reminders.



WARNING: This manual provides essential instructions for the proper setup, inspection, use, and care of your new regulator. Because Apeks regulators utilize patented technology, it is very important to take the time to read these instructions in order to understand and fully enjoy the features that are unique to your specific model. Improper use of your regulator could result in serious injury or death.

Contents

General Precautions & Warnings	4
Introduction	5
Using Enriched Air Nitrox (EAN)	6
Overview of Features	8
Second Stage Configuration	8
Diver Changeable Exhaust System (DCE)	9
External Second Stage Adjustments	11
<i>Integrated Venturi System</i>	11
<i>Inhalation Resistance Control Knob</i>	12
Egress Second Stage	13
First Stage Environmental Protection	14
<i>Second Stage Cold Water Protection</i>	14
Preparation and Setup	15
Hose Attachment	15
Attaching the First Stage to the Cylinder Valve (Yoke)	16
Attaching the First Stage to the Cylinder Valve (DIN)	18
<i>DIN to Yoke Converter</i>	19
Diving with Your Regulator	20
Pre-Dive Inspection Checklist:	20
During the Dive	21
Diving In Cold Water	22
After the Dive	24
<i>Removal of the Regulator from the Cylinder Valve (Yoke)</i>	24
<i>Removal of the Regulator from the Cylinder Valve (DIN)</i>	24
Care & Maintenance	25
Dealer Service & Repair	27
Warranty Information	28
Limited Lifetime Warranty	28
Restrictions	29
Returning Your Regulator for Service	30
ServiceRecord	31

General Precautions & Warnings

- Before using this regulator, you must receive instruction and certification in SCUBA diving from a recognized training agency (or any U.S. Military or government operated diving school). **Use of SCUBA equipment by uncertified or untrained persons is dangerous and can result in injury or death.**
- This regulator is not configured for commercial use with surface supplied air.
- Always pressurize the regulator gradually by opening the cylinder valve SLOWLY.
- NEVER apply any type of lubricant to any part of the regulator or cylinder valve.
- DO NOT apply any type of aerosol spray to the regulator. Doing so may cause permanent damage to certain plastic components, including the second stage housing.
- Factory prescribed service for this regulator must be performed at least once annually by a factory trained Apeks service technician who is employed by an authorized dealer. Disassembly, repair, or first stage adjustment must not be attempted by persons who are not factory trained and authorized by Apeks.
- DO NOT leave a cylinder standing unsecured with the regulator attached to the valve. Doing so may cause permanent damage to the regulator and cylinder valve if the cylinder falls over.
- DO NOT carry the regulator by the first stage when it is connected to a cylinder. Always carry the cylinder by the cylinder valve or an attached carrying device.
- When diving in cold water (below 50°F, or 10°C), you must have received training and certification in the techniques of cold water diving from a recognized training agency.

INTRODUCTION

Congratulations—and thank you—for choosing Apeks. All Apeks regulators have been designed and manufactured with pride, according to standards which meet or surpass all requirements for the BS EN ISO 9001 quality control system.

Your Apeks regulator is covered by Apeks' Limited Lifetime Warranty against defects in materials or workmanship. This warranty is only extended to the original purchaser, however, and is not transferable. For more information, be sure to read the warranty section of this manual, and remember to save your sales receipts. Copies of these receipts must be presented whenever obtaining warranty service.

Perhaps more than any other piece of diving equipment you will own, your regulator's function and performance relies greatly on the care and maintenance it will receive, in addition to regularly scheduled dealer service. Before you dive with your new Apeks regulator, it is therefore important to read this manual in its entirety to become familiar with its features, as well as the correct procedures for setup, pre-dive inspection and post-dive maintenance.

Please read on to learn how you can obtain the maximum enjoyment from your regulator, and maintain its like-new performance for many years to come.



WARNING: Improper use or misuse of SCUBA equipment may result in serious injury or death. Read and understand this owner's manual completely before diving with your Apeks regulator.

USING ENRICHED AIR NITROX (EAN)



WARNING: This section of your owner's manual contains important information regarding the use of your equipment with enriched air (EAN/Nitrox). Do not attempt to use this product with enriched air until you have read and understand this section of the manual. To do otherwise increases your risk of injury or death.



WARNING: Obtain an EAN (Nitrox) Certification. In order to enjoy the special benefits that EAN/nitrox can provide, it is extremely important to obtain special training from a nationally recognized training agency in addition to that which is provided for openwater scuba.

Your Apeks regulator has been prepared for use with Enriched Air Nitrox (EAN) where the percentage of oxygen in the EAN does not exceed 40%. This is possible because each regulator is built to a high standard of cleanliness using EAN compatible components and lubricants. In addition, each regulator design has passed stringent adiabatic compression testing to ensure its safety and compatibility with increased percentages of oxygen.

If it is your intention to use your new Apeks regulator with EAN (O_2 not to exceed 40%), it is imperative that you maintain the internal cleanliness of the regulator (see section on Care and Maintenance). If it is your intent to use the regulator interchangeably with breathing air, the breathing air should be oxygen-compatible or "hyperfiltered" whereas the condensed hydrocarbons do not exceed 0.1 mg/m³. Your local authorized Apeks dealer can help you determine whether the breathing air that they provide meets this criterion.

Standard compressed breathing air, often referred to as Grade E in the United States, does not necessarily meet this criterion. Grade E breathing air may contain a certain level of hydrocarbons, including traces of compressor oils that while not considered harmful to breathe, can pose a risk in the presence of elevated oxygen content.

Passing hydrocarbons through a valve and regulator creates a cumulative effect where the hydrocarbons build up over time along the internal passageways of the equipment. When these hydrocarbons come in contact with high-pressure oxygen enriched air, they can pose a very real hazard that can lead to combustion.

Therefore, if a regulator has had use with Grade E breathing air, it should be returned to an authorized Apeks dealer for overhaul service including hydrocarbon cleaning, prior to being put back into nitrox service.

Although second stage components are not exposed to high pressure EAN, Apeks recommends that the same cleaning procedures be followed for the complete regulator. This prevents the possibility of cross contamination and guarantees the cleanliness of the entire regulator.



NOTE: *Apeks offers additional models of regulators that are designed and manufactured for use with enriched air nitrox where the percentage of oxygen exceeds 40%. For information about these models, consult your authorized Apeks dealer.*

OVERVIEW OF FEATURES

The Apeks family of regulators consists of different models which satisfy a wide range of diving interests; from entry level sport diving, to advanced diving in more demanding and extreme conditions. By now, your authorized dealer has already explained to you the specific features that your particular model offers, and you have made your purchase after comparing the benefits of these features to your personal diving needs and interests. Be sure to review this section to learn more about your model's features and how to obtain the maximum benefit from using them. The XTX range offers two features unique to XTX. The option for either left or right hand hose configuration and the Diver Changeable Exhaust system (DCE).

Second Stage Hose Configuration

Apeks XTX regulator range can be dedicated to either left or right handed use in conjunction with the RVS system (see page 11). The hose routing can be altered from right hand to left or from left hand to right by your Authorized Apeks Dealer. This is an extremely useful feature offering much greater flexibility for personal kit configuration.

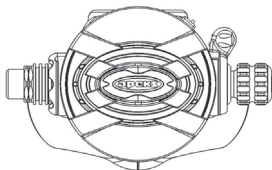

Right Hand

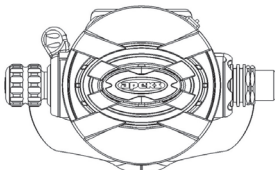

Left Hand



NOTE: This conversion must only be performed by a factory trained Authorized Apeks Service Technician who is employed by an Authorized Dealer. Contact your Authorized Apeks Dealer for further information on this feature. Disassembly, adjustment or repair must not be attempted by persons who are not factory trained and authorized by Apeks.

Diver Changeable Exhaust system (DCE)

The Diver Changeable Exhaust (DCE) offers the choice of either a compact lightweight system or a longer exhaust diffuser. DCE can be configured to prevent virtually any bubble interference from obscuring the diver's view.

The exhaust diffusers can be easily and very quickly changed by sliding and locking the preferred set into place. Divers can now configure their own regulator exhaust diffusers for individual dive conditions or requirements.

By pressing the securing button in the centre of the exhaust diffuser and at the same time sliding the diffusers apart, they can be removed quickly and easily.

To attach an alternative set of exhaust diffusers, align the slide locations as shown and slide each side into place, taking care that the exhaust diffusers are located securely. When the two diffusers meet squeeze them together until an audible click is heard from the retaining button.

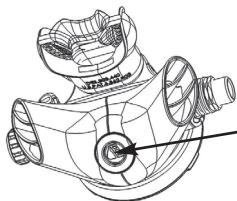

1. First gently press the button located in the center of the exhaust diffuser.



CAUTION! Do not use any tools to aid the removal of the exhaust diffusers.

2. Then slide both exhaust diffusers apart, while keeping the button depressed.

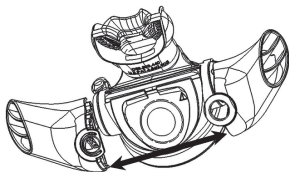



CAUTION! Ensure location grooves are free from dirt and debris.

- Refitting the exhaust diffusers is carried out by sliding ONE diffuser at a time onto the case, once both diffusers are located on the case, squeeze the two diffusers together until you hear an audible “click”.



NOTE: The removal and refitting of the small exhaust diffusers is carried out in exactly the same way as the large exhaust diffusers.

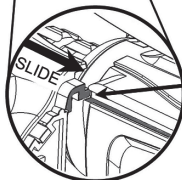
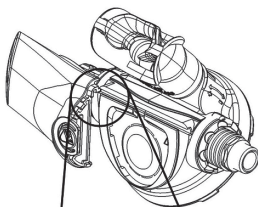

Location Groove

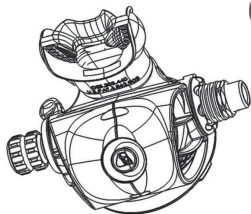

NOTE: If the exhaust diffusers do not securely clip together then they may become detached and lost. (If required, exhaust diffusers may be purchased separately).



WARNING: Do not attempt to use tools to remove or attach the exhaust diffusers. After the removal of the exhaust diffusers care must be taken to prevent damage to the exhaust valve. Do not attempt to poke, pull or touch the exhaust valve or surrounding area with any tools. If damage to this part or

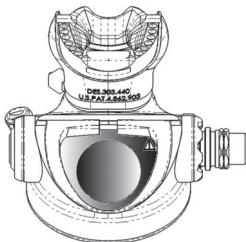

Shaded area indicates exhaust valve and surrounding area.

surrounding area occurs then this could cause your regulator to leak, causing serious malfunction or even personal injury. Care must be taken when securing alternative sets of diffusers, do not apply excessive force as damage may occur to the diffusers, exhaust valve or surrounding area.

External Second Stage Adjustments

External adjustment features offer many advantages, including the ability to adjust your second stage regulator's sensitivity as your diving conditions change. This can allow you to maintain peak performance throughout every dive, or to desensitize your regulator's opening effort at times when you are not breathing from it.

Integrated Venturi System

Apeks second stages are equipped with a unique Integrated Venturi System (IVS) control switch or Reversible Venturi System (RVS) switch, located on the opposite side to the hose connection of the second stage, that controls the venturi assist to reduce sensitivity to freeflow at the surface and provide maximum airflow at depth.

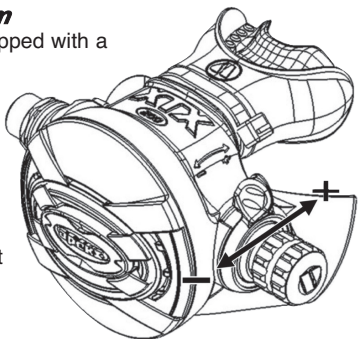

While diving set the switch to plus (+) to achieve maximum venturi assistance for easier breathing.

To prevent the second stage from free-flowing, set the IVS/RVS to the MIN(-) setting whenever the regulator is out of your mouth.

Inhalation Resistance Control Knob

Some second stage models are equipped with an additional adjustment, which controls inhalation resistance.

This control knob, located beside the IVS/RVS switch, adjusts the amount of effort required to start the air flow at the beginning of the inhalation cycle. As it is turned “in” (clockwise), the opening effort will increase. This will make the second stage less sensitive to sudden changes in ambient pressure. Turning the knob “out” (counter-clockwise) will decrease the opening effort to make breathing easier.

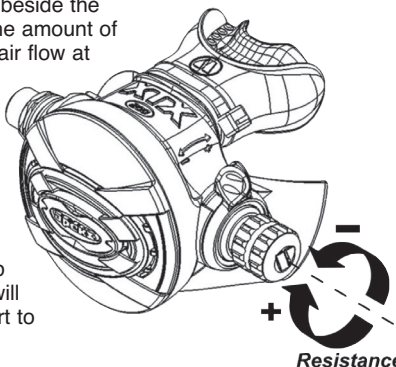

This adjustment is particularly useful at deeper depths, or in variable conditions that affect the opening effort of the second stage, such as strong currents or while using a diver propulsion vehicle (DPV). You can use the inhalation control knob to tune your regulator to maintain its peak performance throughout the course of your dive, or you can leave it set in its mid-range position and dive with it as you would any non-adjustable second stage.

For more information on using these adjustments, refer to the section titled, *Diving With Your Regulator*, on page 20.

Egress Second Stage

The Egress is a low profile second stage suitable for use in all diving conditions, and can be used either way up due to its side exhaust and hose layout. Therefore the diver can use the second stage with the hose routed from either the left or right depending on personal preference and setup requirements.

The Egress second stage is primarily aimed for use as an alternative air source second stage although can still be used successfully as a primary second stage. The Egress also incorporates the patented thermodynamic heat exchanger technology which makes it suitable for diving in water temperatures below 10°C, see page 22

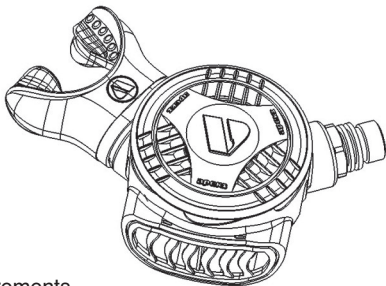

First Stage Environmental Protection

For diving in contaminated or cold water conditions, some Apeks first stages feature a unique “DRY” environmental sealing system which completely eliminates the need for messy silicone oil or grease filling. An external diaphragm seals the ambient chamber from the surrounding sea water, while a specially designed piston transfers ambient water pressure to the internal diaphragm.

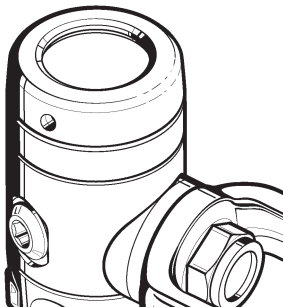

This helps to prevent ice from forming inside the ambient chamber, and also extends the life of the first stage internal diaphragm. It is important to remember, however, that this environmental protection will not completely prevent the second stage from icing or freezing.

Second Stage Cold Water Protection

With the exception of the XTX20, AT20 & T20, Apeks second stages incorporate a thermo-dynamic heat exchanger at the second stage hose fitting. This patented (Patent No. U.S. Pat. 5,265,596) feature is designed to draw in the surrounding water temperature, thereby warming the valve mechanism and greatly reducing the possibility of second stage freeze-up.

For important information about diving in cold water, refer to the section titled, Diving in Cold Water, on page 22.

PREPARATION AND SETUP

Hose Attachment

Apeks recommends that you take your regulator to your authorized dealer for the installation of any accessory items, including instrumentation, medium pressure (MP) quick disconnect hoses, and alternative air source second stages. Your dealer can also answer any questions you may have pertaining to the information in this manual. If it is not possible to return your regulator and accessories to your Apeks Authorized Dealer, you may install the accessories yourself carefully performing the steps in the following procedure.



WARNING: DO NOT connect medium pressure hoses (inflator hoses and second stage hoses) to high pressure (HP) ports. This will cause medium pressure hoses to burst when pressurized, which can result in serious injury. High pressure ports are identified by the letters 'HP' on your regulator and are mainly used for instrumentation and air integrated computers.

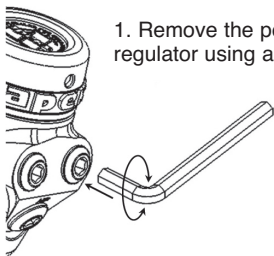

1. Remove the port blanking plug from your first stage regulator using a 5mm Allen key.



NOTE: Care must be taken when using a spanner/wrench when tightening the hose connections. The spanner can score and damage the chrome plating finish of first stage body around the port area.

2. Ensure the O-ring is present and in good condition on the hose to be fitted. Screw the threaded end of the hose into the port making sure that the thread is screwed in square to the port. Tighten to 46 kg/cm (40 lbs/in) using an appropriate sized spanner.



1. Check the second stage IVS/RVS control switch to ensure that it is set to the “MIN” (–) position prior to connecting your regulator to the tank.
2. If present, gently turn the inhalation control knob “in” (clockwise), only until it stops. Do not apply excessive pressure.
3. If you are using a cylinder with a yoke connection valve, check the cylinder valve O-ring is fitted and not worn or damaged. If you are using a high pressure cylinder with a DIN connection valve, remove the protector cap from the first stage to inspect the sealing O-ring of the DIN connector. If the sealing O-ring is damaged or worn, replace it before mounting the regulator on the cylinder valve.

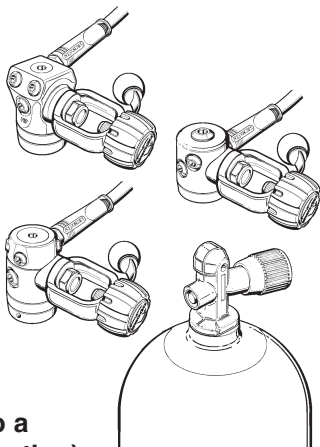

Attaching the First Stage to a Cylinder Valve (Yoke Connection)



WARNING: OPEN VALVES SLOWLY TO AVOID OVER-PRESSURIZATION. When pressurizing your SCUBA system, be sure to open the cylinder valve slowly to minimize the generation of heat. Failure to do so, with Enriched Air Nitrox (EAN) present, increases the risk of combustion that can lead to serious injury or death.

It is considered safe practice, especially when using EAN, to open the cylinder valve slowly and let the first stage pressurize slowly. Rapid pressurization causes adiabatic compression of the breathing gas, which generates heat inside the first stage. Heat, along with elevated percentages of oxygen and an ignition source (from contamination) are the ingredients that can cause combustion. This is why it is

necessary to keep the interior of the regulator clean and the percentage of oxygen below 40% along with the slow opening of the cylinder valve (for regulators over 40% oxygen please see page 6).

To attach a yoke-style first stage to the cylinder valve, follow these steps:

1. Partially unscrew the yoke screw of the first stage regulator so that the dust cap can be removed from the air inlet.
2. With the cylinder valve facing away from you, release a small amount of air from the cylinder by turning the hand-wheel counter-clockwise to open the valve only slightly. When air is heard exiting, immediately close the valve. This will clear any moisture or debris that may be inside the cylinder valve outlet opening. Check the O-ring is still in place.
3. Place the first stage regulator over the cylinder valve so that the inlet fitting aligns with the O-ring of the cylinder valve, and the LP hose of the primary second stage will be routed over the desired shoulder. While holding the first stage in place, turn the yoke screw clockwise. Ensure that the yoke screw mates into the small dimple on the backside of the cylinder valve, and tighten finger-tight only - **do not over tighten**.
4. If a submersible pressure gauge is attached to the first stage, ensure that the gauge is facing away from you. Pressurize the regulator by slowly turning the cylinder valve handwheel counter-clockwise. Continue to turn the valve handwheel counter-clockwise until it is fully open, and then turn it back $1/2$ turn.
5. Listen near the first stage to check for any leakage. If leakage is detected, immerse the first stage and cylinder valve while pressurized to determine the source.
6. If leakage has been detected, follow the procedure for removing the regulator from the cylinder valve on page 20. If air was leaking between the first stage and cylinder valve, replace or re-seat the cylinder valve O-ring as needed and repeat the above procedure. If leakage persists, return the system to an authorized dealer.

Attaching the First Stage to a Cylinder Valve (DIN)



WARNING: OPEN VALVES SLOWLY TO AVOID OVER-PRESSURIZATION. When pressurizing your SCUBA system, be sure to open the cylinder valve slowly to minimise the generation of heat. Failure to do so, with Enriched Air Nitrox (EAN) present, increases the risk of combustion that can lead to serious injury or death.

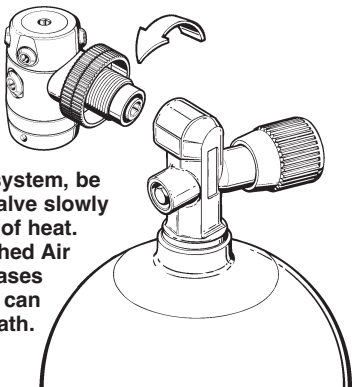

It is considered safe practice, especially when using EAN, to open the cylinder valve slowly and let the first stage pressurize slowly. Rapid pressurization causes adiabatic compression of the breathing gas, which generates heat inside the first stage. Heat, along with elevated percentages of oxygen and an ignition source (from contamination) are the ingredients that can cause combustion. This is why it is necessary to keep the interior of the regulator clean and the percentage of oxygen below 40% along with the slow opening of the valve.

To attach a DIN-style first stage to the cylinder valve, follow these steps:

1. Remove the protector cap from the cylinder valve, if fitted. With the cylinder valve facing away from you, release a small amount of air from the cylinder by turning the handwheel counter-clockwise to open the valve slightly. When air is heard exiting, immediately close the valve. This will clear any moisture or debris that may be inside the threaded cylinder valve opening.
2. Position the first stage near the cylinder valve so that the LP hose of the primary second stage will be routed over the desired shoulder. Thread the first stage DIN connector into the cylinder

valve and tighten the handwheel by hand until it is lightly snug. DO NOT use tools to tighten.

3. If a submersible pressure gauge is attached to the first stage, ensure that the gauge is facing away from you. Pressurize the regulator by slowly opening the cylinder valve handwheel. Continue to turn the cylinder valve handwheel until fully open, and then back $1/2$ turn.
4. Listen near the first stage to check for any leakage. If leakage is detected, immerse the first stage while pressurized to determine the source.
5. If leakage has been detected, follow the procedure for removing the regulator from the cylinder valve on page 24. If air was leaking between the first stage and cylinder valve, replace or re-seat the cylinder valve O-ring as needed and repeat the above procedure. If leakage persists, return the cylinder and regulator to an authorized dealer.

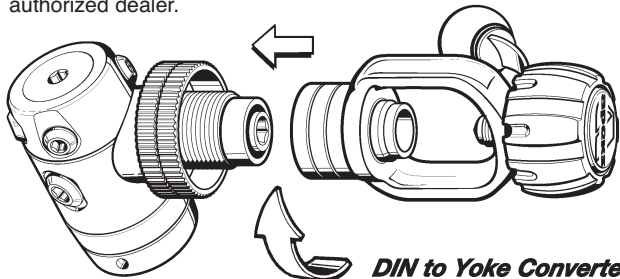

DIN to Yoke Converter

For regulators which may be used back and forth between Yoke and DIN connections, Apeks offers a convenient DIN to Yoke converter. First, obtain factory prescribed installation of the DIN connector through an authorized dealer. Then, simply attach the converter to connect your regulator to a yoke valve.



WARNING: Adaptors from yoke 1st stage to a DIN cylinder valve must never be used. This would allow a greater working pressure to be used than the yoke connector is designed to take.

DIVING WITH YOUR REGULATOR

Before each use, it is important to perform a complete pre-dive inspection of your regulator. NEVER dive with a regulator that shows signs of damage or unsatisfactory performance until it has received complete inspection and service from an authorized dealer.

Pre-Dive Inspection Checklist:

1. Carefully inspect all hoses at their fittings to ensure they are securely connected into their respective ports on the first stage. Inspect the length of each hose to ensure that the hoses are not blistered, cut, or otherwise damaged. If hose protectors are present, slide the protectors back to expose the hose fittings, and inspect the hoses as described above.
2. Visually inspect both the first and second stage regulators for any signs of external damage.
3. **Environmentally sealed first stages only:** Closely inspect the external sealing diaphragm for any signs of damage or deterioration that may cause leakage. Check to ensure that the retainer which holds the external diaphragm in place is tightly secured.



WARNING: If the external diaphragm shows any signs of damage or neglect, DO NOT attempt to dive with the regulator until it has received factory prescribed service from an authorized dealer. The regulator's performance may be compromised, and first stage freeze-up could occur in cold water conditions.

4. Connect the first stage regulator to a fully charged SCUBA cylinder. (For mounting instructions, read the Setup section on pages 15-19.) SLOWLY open the cylinder valve to pressurize the regulator. Continue turning the valve counter-clockwise until it stops, and then back $\frac{1}{2}$ turn. This is to ensure that the valve is completely open.
5. If present, turn the inhalation control knob completely "out" (counter-clockwise), and then back "in" (clockwise) until the

regulator provides maximum ease of breathing with no leakage present. Do not apply excessive pressure.

6. Depress the purge button momentarily to blow out any dust or debris which may have entered the second stage. Release the purge button and listen to ensure that the second stage does not continue to flow any air after the purge button is released.
7. Inhale slowly and deeply from the regulator several times. The regulator must deliver enough air for you to breathe easily without noticeable resistance.
8. Check to ensure that the submersible pressure gauge is displaying an accurate measurement of the air pressure inside the cylinder.
9. Check to ensure that the IVS control switch is set to "MIN". If present, gently turn the inhalation control knob completely "in" (clockwise), only until it stops. Do not apply excessive pressure. These settings will help to minimize any loss of your air supply during entry or while making a long surface swim.

During the Dive

When you are ready to submerge, place the second stage in your mouth and set the IVS switch at a position between MIN and MAX that feels comfortable to you. If present, turn the inhalation control knob out (counterclockwise) until the regulator breathes comfortably without leaking or being undesirably sensitive.



NOTE: *It is acceptable for the second stage to continuously leak air when the inhalation control knob is turned all the way "out" (counter-clockwise), in order to provide the maximum range of adjustment.*

As you descend, you may want to turn the IVS switch further towards MAX, and the inhalation control knob further out to make breathing easier. This will be particularly true on deep dives where the air becomes denser. Remember, however, that the regulator may continuously leak air if the inhalation control knob is turned completely "out," and this will cause the air supply to be depleted more rapidly.



WARNING: Adjusting your regulator to increase breathing resistance will not conserve air. Instead, excessive breathing resistance will actually increase air consumption, and may elevate the CO₂ in your bloodstream to a dangerous level which could lead to serious injury or death due to drowning if you lose consciousness.

If you swim underwater in an upside down or sideways position, or facing a strong current, you can turn the inhalation control knob back “in” (clockwise), to desensitize the opening effort to prevent any freeflow.

At the end of your dive, be sure to return the IVS switch to the MIN position, and turn the inhalation control knob “in” when you have arrived at the surface.

WARNING: Deep diving requires special training and equipment, and greatly increases your risk of decompression sickness and other serious diving injuries. If you attempt to dive beyond prescribed no-decompression limits without first obtaining sanctioned technical dive training, you risk serious injury and death.

Diving In Cold Water

The C.E.N. standard defines cold water as 50°F (10°C) or lower. In such conditions, there is a risk of freeze-up; particularly in fresh water, which has a higher freezing point and more severe thermoclines. Incidents of first or second stage freeze-up usually result in freeflow from the second stage, resulting in a rapid loss of air.

Before attempting an unsupervised dive in cold water conditions, it is important for you and your buddy to obtain certified training in cold water diving techniques, and to use only equipment which has been specifically designed and maintained for such use. If these precautions are not taken, freeze-up can occur. It is possible for icing or freeze-up to occur, even with a regulator that has been specially designed for cold water use. It is therefore imperative to practice the correct cold

water diving procedures, and take special precautions to prevent second stage icing. This training must include procedures for dealing with regulator freeze-up, unexpected freeflow, and emergency out-of-air situations. These procedures are taught in cold water training programs provided by most recognized certification agencies.

The following measures will further reduce the risk of freeze-up:

1. Request verification from your dive store that the air in your cylinder(s) is dry. It should have a dew point below -82°F or -54°C . Excess water vapor can freeze, causing a freeflow condition, or blocking the flow of air entirely.
2. Protect your regulator from any contact with water until the moment that you are ready to begin your dive.
3. Protect your equipment from cold temperatures before the dive. Keep your regulator and all its accessories in a warm, dry place.
4. Avoid breathing through the regulator or pressing the purge button in very cold air before entering the water.
5. Avoid removing the regulator from your mouth during the dive. This will prevent cold water from entering the regulator's second stage.
6. As far as is possible, avoid heavy exertion during the dive in order to minimize the volume of air flowing through the regulator.



WARNING: SCUBA regulators and equipment have operational limits when used in water colder than 50°F (10°C). If you attempt to dive in cold water without first obtaining the necessary training and preparation of your equipment, you risk serious injury or death.

AFTER THE DIVE



NOTE: *If fresh water is available, rinse your regulator completely before depressurizing it, and thoroughly dry the first stage and cylinder valve. This will help to prevent any contaminants from entering the regulator when it is removed from the cylinder.*

Removing the Regulator from the Cylinder Valve (Yoke Connector)

1. Shut off the cylinder air supply by turning the cylinder valve handwheel clockwise until it stops.
2. While observing the submersible pressure gauge, depress the purge button of the second stage. When the gauge reads zero and airflow cannot be heard from the second stage, release the purge button.
3. Turn the yoke screw counterclockwise to loosen and remove the first stage from the cylinder valve.
4. Dry the dust cap with a clean towel, or with low pressure air.
5. Place the dust cap over the first stage inlet fitting and seal it securely in place by tightening down the yoke screw.

Removing the Regulator from the Cylinder Valve (DIN Connector)

1. Turn off the cylinder air supply by turning the cylinder valve handwheel clockwise until it stops.
2. While observing the submersible pressure gauge, depress the purge button of the second stage. When the gauge reads zero and airflow cannot be heard from the second stage, release the purge button.
3. Turn the first stage handwheel counterclockwise to loosen and remove the first stage from the cylinder valve.
4. Blow out any water inside the protector cap or wipe it out with a soft cloth, and wipe the threads of the first stage connector clean and dry. Install the cap over the threads of the first stage connector.



CAUTION: Be careful when removing the first stage from the cylinder valve to ensure that moisture does not enter either the inlet opening of the first stage or the opening of the DIN valve.

5. With the cylinder valve facing away from you, open the valve slightly to release a short burst of air, and then immediately close the valve. This will clear any moisture that may have entered the valve opening. Immediately seal the protector cap securely in place over the opening of the DIN valve to prevent the entrance of moisture or debris.

Care & Maintenance

It is important to provide the proper preventative maintenance in order to ensure the best possible performance and maximum life of your Apeks Regulator. The following maintenance procedures should be performed routinely after each use to ensure that the regulator is cleaned, inspected, and prepared for the next use or for storage.

1. Whenever the regulator is removed from the cylinder valve, it is important to wipe or blow the dust cap completely dry, and then fasten it securely over the first stage inlet fitting. This is critical to prevent the entrance of moisture into the first stage.
2. As soon as possible after diving, the regulator should be rinsed thoroughly with fresh water while it is attached to a cylinder and pressurized with air.
3. Rinsing alone, however, will not sufficiently clean the regulator. To clean the regulator as thoroughly as possible, it is necessary to soak it in warm (not over 120°F) tap water for at least one hour.
 - a. The preferred method is to attach the regulator to a charged SCUBA cylinder, open the cylinder valve to pressurize the regulator, and thoroughly soak both the first and second stages. Pressurizing the regulator will effectively prevent the entrance of moisture and/or contaminants into the regulator while it soaks.
 - b. If it is not feasible to soak the regulator while it is attached to a cylinder, it may be soaked unpressurized – provided that the dust

cap is securely sealed over the inlet, and the second stage purge buttons are not depressed while the regulator is submerged or wet.



NOTE: When soaking or rinsing an adjustable model regulator unpressurized, check to ensure that the second stage inhalation control knob is turned completely “in” (clockwise) to prevent moisture from entering the valve and LP hose.



CAUTION: DO NOT loosen the first stage yoke screw, depress the second stage purge button, or turn out the inhalation control knob (if present) if the regulator is submerged unpressurized. Doing so will allow the entrance of moisture, and will require that the regulator be returned to an authorized dealer for service.

4. While the regulator is soaking, move the IVS control switch (if present) back and forth several times from the “MIN” to the “MAX” settings. You may also turn the inhalation control knob slightly back and forth—no more than 4 turns. This action will help to loosen any salt or mineral deposits that may remain lodged in the second stage.
5. After the regulator has been properly soaked, it is important to rinse it vigorously by flushing the first stage ambient chamber (non-environmentally sealed models only), the second stage mouthpiece, and the openings in the second stage front cover with a pressurized stream of water. This will remove any deposits of salt and minerals that were loosened during soaking. If the regulator is not pressurized, do not press the purge button underwater. Moisture may otherwise enter the valves, which will require that the regulator be returned to an authorized dealer for service.
6. Wipe the regulator as dry as possible and hang by the first stage to ensure that all remaining moisture drains from the second stages.
7. Adjustable models should be stored with the inhalation control knob turned all the way out (counter-clockwise), away from the

regulator body. This will help to extend the life of the low pressure seat.

8. When the regulator is completely dry, store it in a clean box or sealed inside a plastic bag. Do not store it where it may be exposed to extreme heat or an electric motor which produces ozone. Prolonged exposure to extreme heat, ozone, chlorine and ultraviolet rays can cause premature degradation of rubber parts and components.
9. Never store the regulator while it is connected to the cylinder valve.
10. Do not use any type of solvent or petroleum based substances to clean or lubricate any part of the regulator. Do not expose any part of the regulator to aerosol spray, as some aerosol propellants attack or degrade rubber and plastic materials.

Dealer Service & Repair

1. It cannot be assumed that a regulator is in good working order on the basis that it has received little use since it was last serviced. Remember that prolonged or improper storage can still result in internal corrosion and/or deterioration of O-ring seals.
2. You must obtain factory prescribed service for your regulator at least once a year from an authorized dealer, regardless of the amount of use it has received. Your regulator may require this service more frequently, depending on the amount of use it receives and the environmental conditions in which it is used.
3. If the regulator is used for rental or training purposes, it will require complete overhaul and factory prescribed service every three to six months. Chlorinated swimming pool water is an especially damaging environment for SCUBA equipment, due to the high levels of chlorine and pH balancing chemicals which cause certain components to rapidly deteriorate.
4. DO NOT attempt to perform any disassembly or service of your regulator. Doing so may cause the regulator to malfunction, and will render the Apeks warranty null and void. All service must be performed by an authorized dealer.

OBTAIN SERVICE FOR YOUR REGULATOR AT LEAST ONCE A YEAR, FROM AN AUTHORIZED DEALER. YOUR PERSONAL SAFETY AND THE MECHANICAL INTEGRITY OF YOUR REGULATOR MAY DEPEND ON IT.

WARRANTY INFORMATION

All warranty transactions must be accompanied by proof of original purchase from an authorized dealer. Be sure to save your sales receipt, and present it whenever returning your regulator for warranty service.

Limited Lifetime Warranty

Apeks warrants to the original purchaser that the product will remain free from defects in material and workmanship throughout its useful life; provided that it receives normal use, proper care, and prescribed dealer service subject to those restrictions stated below.

This warranty does not apply to units subjected to misuse, abuse, neglect, modification, or unauthorized service.

This limited warranty is extended only to the original purchaser for products purchased directly from an authorized dealer, and is not transferable.

This warranty is limited to repair or replacement only at the discretion of Apeks.



WARNING: It is dangerous for untrained and uncertified persons to use the equipment covered by this warranty. Therefore, use of this equipment by an untrained person renders any and all warranties null and void. Use of SCUBA equipment by anyone who is not a trained or certified diver, or receiving training under the supervision of an instructor, could lead to serious injury or death.

This warranty gives you specific legal rights. You may have rights which vary from state to state and country to country.

APEKS DISCLAIMS AND EXCLUDES ANY LIABILITY FOR INCIDENTAL OR CONSEQUENTIAL DAMAGES. SOME STATES IN THE U.S. AND CERTAIN FOREIGN COUNTRIES DO NOT ALLOW EXCLUSIONS OR LIMITATIONS OF LIABILITY FOR INCIDENTAL OR CONSEQUENTIAL DAMAGES, SO THIS MAY NOT APPLY TO YOU.

Restrictions

The following restrictions apply to this warranty:

1. This warranty does not cover normal wear. Factory prescribed service by an authorized dealer is required at least once annually.
2. This warranty does not extend to damages caused by improper use, improper maintenance, neglect, unauthorized repairs, modifications, accidents, fire, or casualty.
3. Cosmetic damage, such as scratches, dents and nicks are not covered by this warranty.
4. This warranty does not extend to equipment used for rental, commercial or military purposes.
5. This warranty covers products purchased in the USA. For warranties that may apply elsewhere, please contact your local representative.

Returning Your Regulator For Service

Whenever your regulator requires annual service or warranty consideration, Apeks requires that you bring it or send it to an authorized Apeks dealer. For help finding a dealer in your area, click on the Dealer Locator at www.aqualung.com or call Aqualung at (760) 597-5000. It is important that you provide the dealer with a copy of your sales receipt and your Annual Service & Inspection Record located in the back of this booklet.



apeks

Regulator Owner's Manual

Manufactured by
Apeks Marine Equipment Ltd.
Neptune Way, Blackburn,
Lancashire BB1 2BT England
www.apeks.co.uk

Distributed in the USA by
Aqua Lung
2340 Cousteau Ct.
Vista CA 92081
www.aqualung.com
www.sea-quest.com

AQUA  LUNG
FIRST TO DIVE